

**MONUMENT RECORD**  
**State of Indiana - County of Monroe**

**Section: 17**

**Township: 8 North**

**Range: 1 East**

**Corner ID: Sa Cr E-11**

**Monument Description & Remarks:** Found Sandstone with faint "+" at West ¼ corner of section. Stone measured 0.35' (h) x 0.68' (l) x 0.33' (w) and was marked with orange flagging. Post south of stone marked with layers of multi-colored flagging.

**References on file in the County Surveyor's Office:** Morgan-Monroe Forest survey by Smith Quillman Associates, dated March 1, 1986.

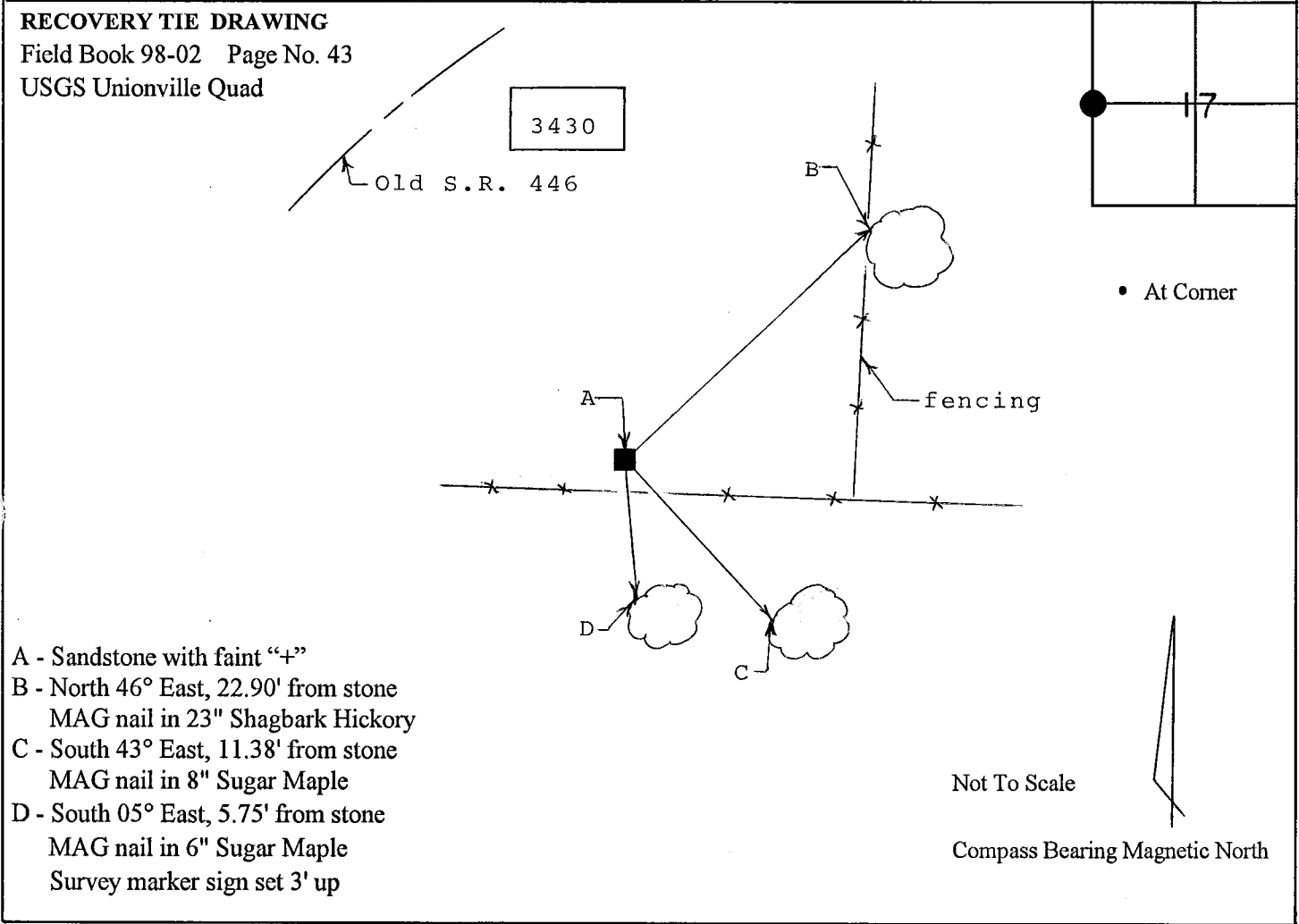

- A - Sandstone with faint "+"
- B - North 46° East, 22.90' from stone  
MAG nail in 23" Shagbark Hickory
- C - South 43° East, 11.38' from stone  
MAG nail in 8" Sugar Maple
- D - South 05° East, 5.75' from stone  
MAG nail in 6" Sugar Maple  
Survey marker sign set 3' up

I, Kevin P. Enright, Monroe County Surveyor, hereby certify that this document was prepared under my direction in accordance with the provisions of Section 36-1-11 of the Indiana Code; and the above data is given under my hand and seal this 2nd day of December, 1998.

*Kevin P. Enright*

